

# Anvilok® Cover Installation

## Product Lines QLA, QLAW

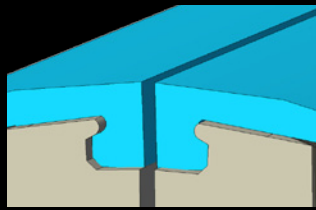

Scan this code or visit [dicar.com](http://dicar.com) to watch instructional video



10 Bloomfield Avenue  
Pine Brook, NJ 07058  
ph: +1-973-575-1377  
toll free: 1-800 323-4227  
email: [info@dicar.com](mailto:info@dicar.com)  
[www.dicar.com](http://www.dicar.com)

### TOOLS



CVR-REM  
Pry Bar

### AnviLatch™ (optional)

The unique **AnviLatch** system increases the efficiency and enhances the safety of mounting rotary diecutting blankets/covers by eliminating the need to use a mallet to lock the cover. For more information visit [dicar.com](http://dicar.com).

### ! CAUTION

Use only tools recommended by Dicar to remove and/or install anvil covers. Use of improper tool may result in injury or damage to covers and/or die cylinder.

### ! IMPORTANT

Prior to installing anvil covers inspect lockup slot for damage, sharp edges or burrs, and ensure slot is free of contaminants to ensure proper lockup.

### ! WARNING

Remove cutting dies prior to removing, installing or rotating anvil covers. Failure to do so can result in personal injury and/or damage to tooling.

## Installation

**1** Install the female end of the cover into the slot, under the lip, as shown.

- Make sure the lock mechanism is open before beginning installation

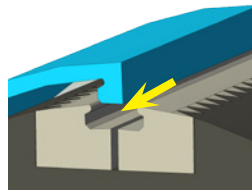

**2** Wrap the blanket around the cylinder and align with the end already installed.

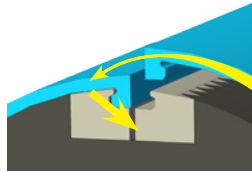

## Removal

**1** Open the lock mechanism per machine manufacturer's instructions.

**2** Place Pry Tool (CVR-REM) between the cover and slot lip as shown. Pry away from lip and then up.

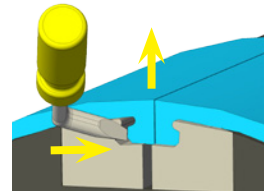

Continue working tool across the cover.

- If rotating, keep blankets off of floor to prevent contamination.

### ! WARNING

To prevent injury, **do not** allow fingers to enter the nip between the die drum and anvil cylinder when rotating cylinder. Keep fingers and hands clear of lockup area when closing mechanism.

### ! CAUTION

Do not attempt to remove the blankets by inserting the pry tool between the blankets and the cylinder surface. Doing so can cause damage to the blankets and/or cylinder.

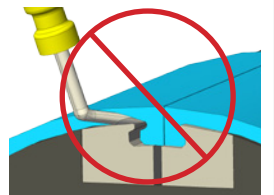

**3** Tighten the mechanism to close the lock section, per the machine manufacturer's instructions.

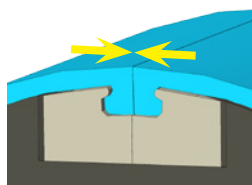

Dicar offers a full range of anvil cover styles and sizes, and other urethane products.

Visit [dicar.com](http://dicar.com), or contact your local Dicar Representative to view our catalog of quality Dicar diecutting and die-making products and services.

